

Setting up a thin client on digi

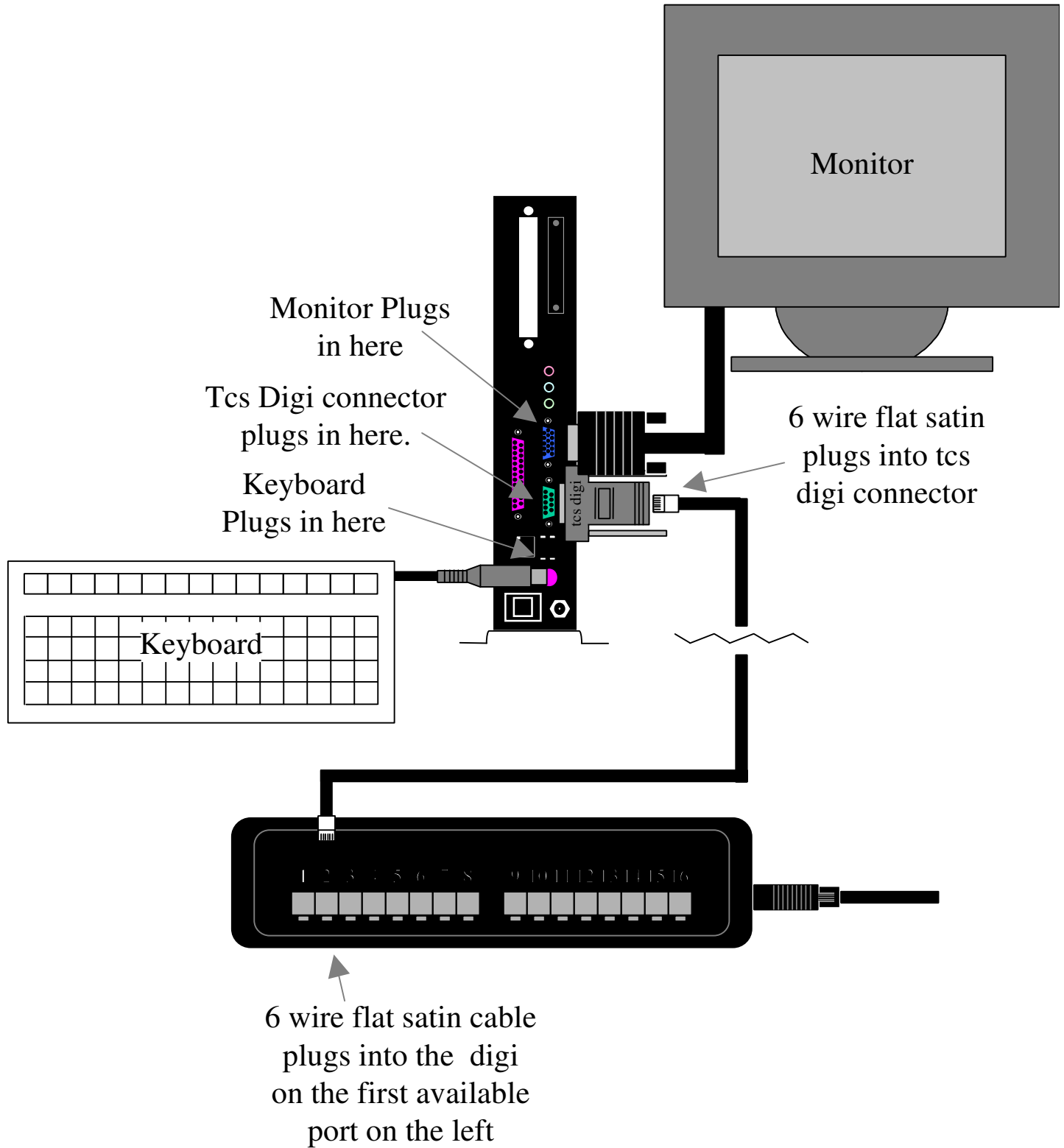

Setting up a thin client on digi

PRE- INSTALLATION SETUP OF SCO SERVER:

Login to your Sco Server as root.

From the prompt type	sysut
Ing the sysut menu select:	Terminal
In the terminal menu select:	Terminal Emulation Menu

Arrow down to the port you are wanting to configure (note that the column on the left represents the port and/or ports ID that you are wanting to configure)

Once you have selected the appropriate menu line, hit the enter key.

The proper setting should look similar to the following. If they do not, then change them:

The terminal emulation should be=	linux
The baud rate should be=	38400
The port should be=	enabled
The comment line should be=	<i>Whatever you want to call this workstation</i>

Once you have completed your setting changes, hit the insert key to save.

```
Tty (device) : a10
Workstation  : 0
Enabled      : Y
Comment      : thin client at point of sale
Baud rate    : 38400      Actual def: abcso
Terminal type: linux
```

TO ACCESS THE TCS SETUP UTILITY REBOOT THE WORKSTATION AND WAIT FOR THE MESSAGE:

**PRESS S FOR TERMINAL SETUP UTILITY
OR WAIT 4 SECONDS FOR NORMAL STARTUP**

When this message appears press the “s” key to enter the setup utility.

Setting up a thin client on digi

You will see a message that says:

PLEASE ENTER THE TYPE OF WORKSTATION (S/C/G/I/Q) :

At this prompt press the “s” key and then press the enter key
The utility program will then display the new workstation setting

NEW WORKSTATION SETTINGS

WORKSTATION TYPE: SERIAL, TEXT ONLY

BAUD RATE SETTING: 38400

EMULATION TYPE: LINUX

IS THIS INFORMATION CORRECT? (Y/N/A)

AT THE PROMPT YOU MAY PRESS “Y” KEY AND THEN THE ENTER KEY IF THE INFORMATION IS CORRECT. THE INFORMATION WILL BE SAVED AS A MESSAGE IS DISPLAYED:

SAVING DEFAULT SETTINGS.....

Your TCS will continue to boot. When it arrives at a prompt that says “PRESS ENTER TO CONNECT TO SERVER,” press enter and you should be at a login.

At this point your terminal should be ready to use.