

# PSC Quick Scan 6000 Plus With Keyboard Wedge

This scanner is designed to connect to any ps/2 style keyboard and keyboard port. It can be connected to an AT style keyboard or keyboard port by means of an adapter. It can be used with the following terminals:

Serial Spot Line

Ethernet Spotline

Thin Client

This scansheet is to be used with a PSC Quick Scan 6000 Plus with a keyboard wedge as pictured below. If the scanner is attached to an American Microsystems, Percon or other type of wedge do not use this document. You will need to use the document for that wedge.

Scan the barcodes from top to bottom, and then continue scanning from top to bottom on the next page. Make sure that you hear at least one beep after the barcode is scanned. These barcodes, when scanned in this order, can be scanned from any point in the software. No information should appear on your screen when scanning this document. If, while scanning this document, information is put on the screen, please rescan the document. If this happens repeatedly, please ensure that you are using the correct scansheet.

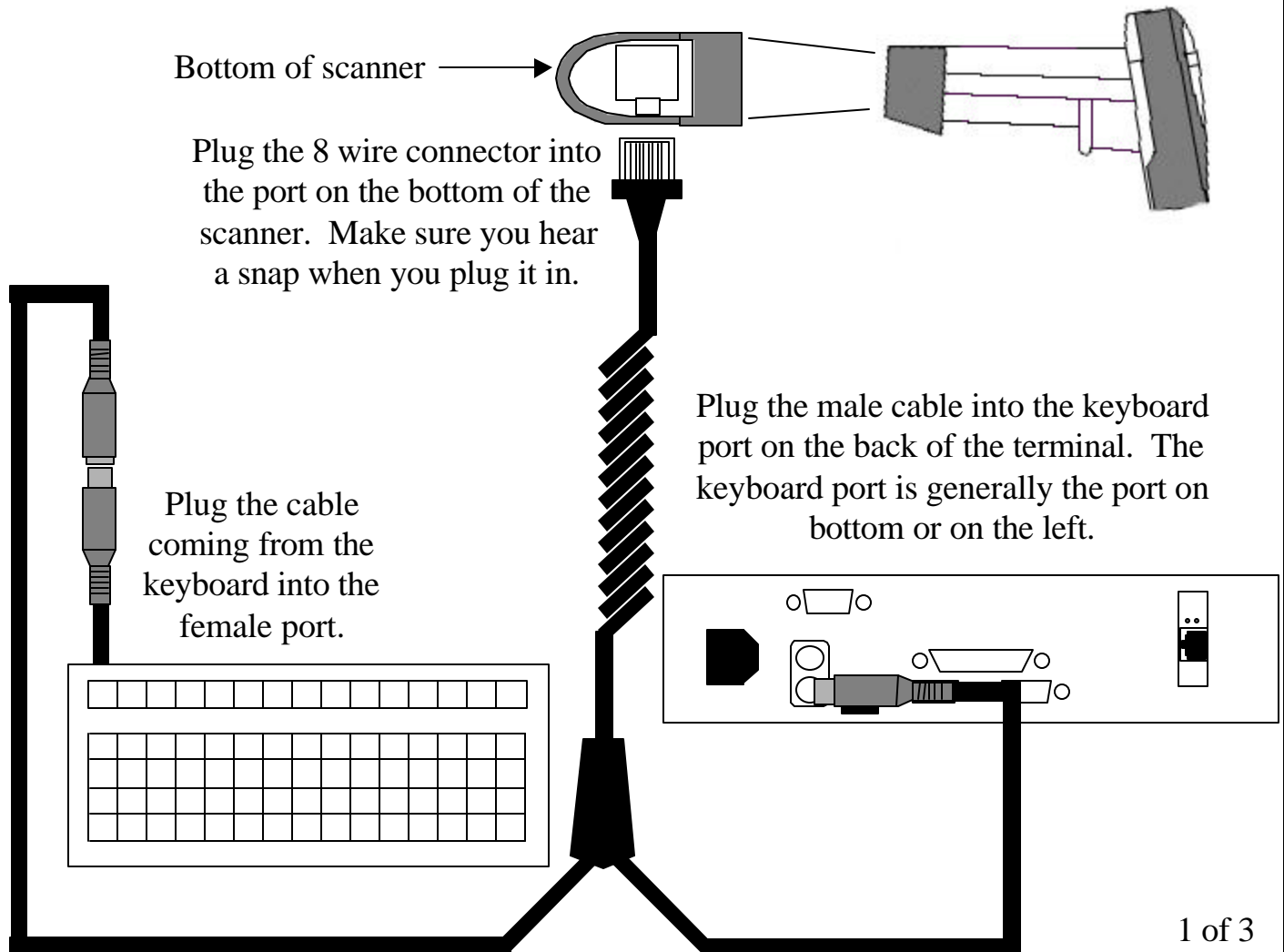

# PSC Quick Scan 6000 Plus With Keyboard Wedge

## Start Here

### Return to Factory Defaults

This barcode will remove all configurations and return the scanner back to its original settings.

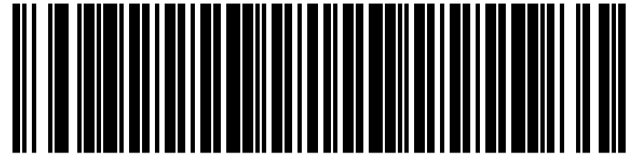

When the scanner is set to defaults it is set to read 12 digits. Most systems use 10 digit barcodes. This section will set the scanner to use 10 digits instead of 12 so that systems that use 10 digit barcodes can understand it. If your system uses 12 digit barcodes do not scan this section. If your system uses 10 digit barcodes or you do not know how many digits you use, continue scanning this section.

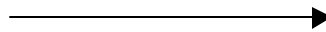

Set

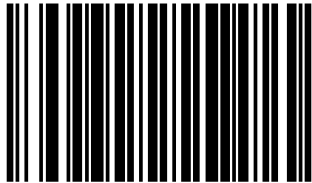

No Check Digit

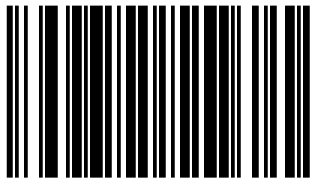

No NSD

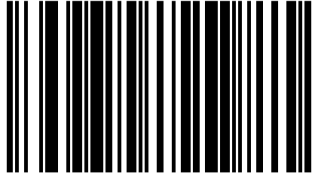

End

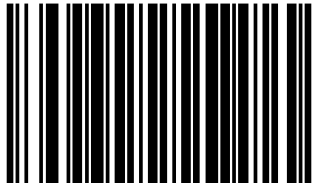

# PSC Quick Scan 6000 Plus With Keyboard Wedge

This section will set the scanner to append two carriage returns to the output of the scanner. This means that when you scan an item in point of sale it will place the cursor on the next line. When the scanner is set to defaults it is set to append only one carriage return. This means that when an item is scanned in point of sale the cursor will stop on the quantity field. If you want the cursor to stop on the quantity field do not scan this section. If you do not want to stop on the quantity field or you do not know, continue scanning this section.

