

Setting up the Model 6710 Produce Scale

Warning: Turn the power off to the server before connecting the scale.

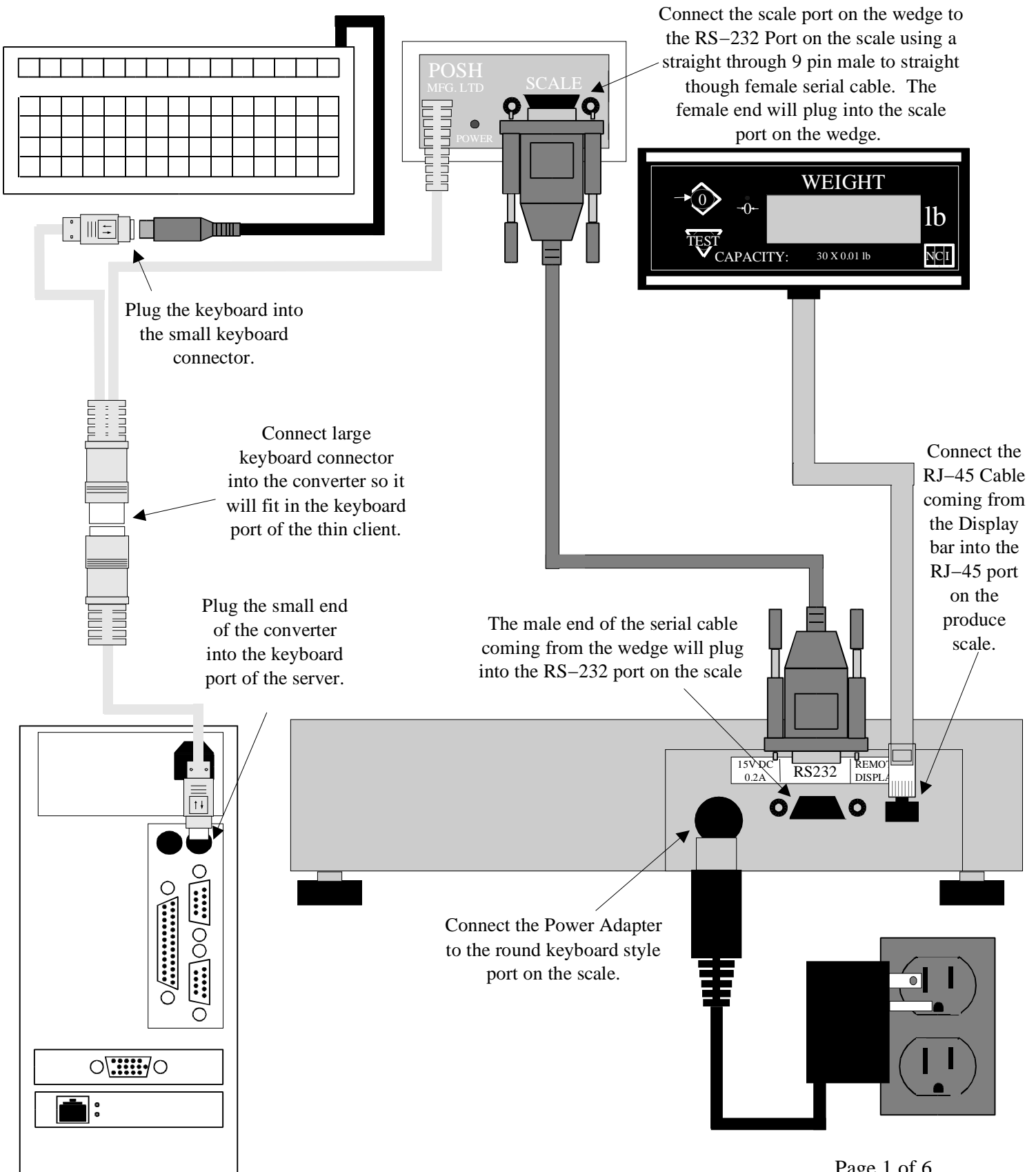

Setting up the Model 6710 Produce Scale

Configuration of the scale can be done only when no one is logged into the system.

1. Connect the produce scale as shown on page 1. Make sure the server is turned off before you begin connecting the scale.
2. Turn the server on and allow it to boot up.
3. Login as root and get to the # prompt.
4. Type in the following command and press enter:
 cd /tmp
5. Type in the following command and press enter:
 nre test
6. Answer y when asked if you want to create this file.
7. At this point you should be in a text editor screen. Press the Alt and Print Scrn buttons at the same time.

The following screen will appear:

```
copy con mr_setup
```

```
main menu – posh mfg. ltd. v5.01
```

```
f1 – track setup           ==>
f2 – preamble/postamble setup ==>
f3 – serial port setup     ==>
f4 – enable setup         yes
f5 – inter-character delay   3
f6 – transmission mode setup ==>
f7 – scale setup           ==>
f8 – sound                 on
f9 – set to factory defaults
```

```
esc – exit setup~ don't save changes
```

```
f10 – save changes to eeprom and exit
```

```
press function key to toggle value
or go to sub-menu
```

Setting up the Model 6710

Produce Scale

8. Press the F9 key to set the wedge back to defaults. You should see the same screen repeated.

9. Press the F2 key to choose the preamble/postamble setup menu.

The following menu will appear:

preamble/postamble setup for all tracks

f1 – send carriage rtn for track 1	yes
f2 – send carriage rtn for track 2	yes
f3 – send carriage rtn for track 3	yes
f4 – send carriage rtn for scale/scanner	yes
f5 – send start and end sentinel	yes
f6 – send any valid track	no
f7 – disable error checking	no

esc – go to main menu~ don't save changes

f10 – keep changes and go to main menu

press function key to toggle value

10. Press the F4 key. The send carriage rtn for scale/scanner option should be switched to no as shown below.

preamble/postamble setup for all tracks

f1 – send carriage rtn for track 1	yes
f2 – send carriage rtn for track 2	yes
f3 – send carriage rtn for track 3	yes
f4 – send carriage rtn for scale/scanner	no
f5 – send start and end sentinel	yes
f6 – send any valid track	no
f7 – disable error checking	no

esc – go to main menu~ don't save changes

f10 – keep changes and go to main menu

press function key to toggle value

Setting up the Model 6710 Produce Scale

11. Press the F10 key to return to the main menu.
12. Press the F10 key again to save your settings and exit setup.
You should see the following:

main menu – posh mfg. ltd. v5.01

f1 – track setup	==>
f2 – preamble/postamble setup	==>
f3 – serial port setup	==>
f4 – enable setup	yes
f5 – inter-character delay	3
f6 – transmission mode setup	==>
f7 – scale setup	==>
f8 – sound	on
f9 – set to factory defaults	

esc – exit setup~ don't save changes
f10 – save changes to eeprom and exit

press function key to toggle value
or go to sub-menu

done setup:
changes saved

13. Press F2 and a menu will appear. Press a to abandon and answer y when asked if you want to abandon your changes.
14. Calibrate the scale. To do this, make sure there is nothing on the scale, then press the enter 0 button on the display bar. This should set the readout to 0.00 and turn on the red 0 light.

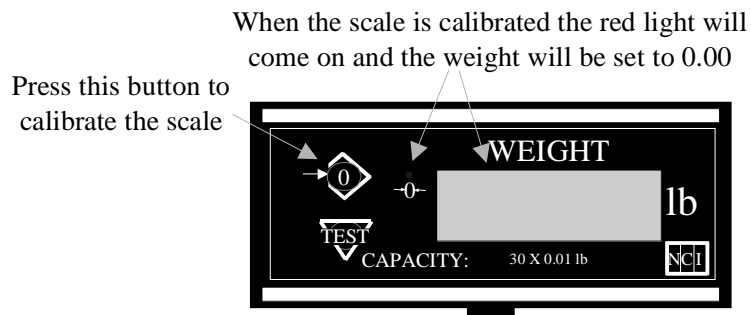

Setting up the Model 6710

Produce Scale

15. From the # prompt type `clist` and press the enter key.
 16. Enter your password when prompted.
 17. Choose your play dataset.
 18. Choose point of sale from the menu.
 19. Choose order entry from the menu.
 20. Enter your password when prompted and press enter.
 21. Press F5 to do a cash sale.
 22. Press F7 and choose an item When you press enter on an item it should take you back to point of sale into the quantity field.
 23. Place something on the scale and press the F12 key. This should put the weight in the quantity field and not advance to the next line or column. The weight should appear exactly as it appears on the display. If this is what occurred proceed to the next step. If this did not occur, return to step 1 and make sure all of your settings and connections are correct.
 24. Press the escape key and answer yes when asked if you want to abandon this new order.
 25. Keep pressing escape until you return to the # prompt.
 26. When you get back to the # prompt shutdown the system by typing in `shutdown -g0 -y` and pressing enter.
 27. When the system says safe to power off or press any key to reboot, turn the power off to the system.
 28. Disconnect the scale and plug the keyboard directly in the keyboard port on the server.
 29. Bring the system back up.
 30. Connect the scale to a terminal as shown on page 6. Make sure the terminal is turned off when connecting the scale to it.
 31. Bring the terminal up and login as root.
 32. From the # prompt type `clist` and press the enter key.
 33. Enter your password when prompted.
 34. Choose your play dataset.
 35. Choose point of sale from the menu.
 36. Choose order entry from the menu.
 37. Enter your password when prompted and press enter.
 38. Press F5 to do a cash sale.
 39. Press F7 and choose an item When you press enter on an item it should take you back to point of sale into the quantity field.
 40. Place something on the scale and press the F12 key. This should put the weight in the quantity field and not advance to the next line or field. The weight should appear exactly as it appears on the display. If this is what occurred proceed to the next step. If this did not occur, return to step 27 and make sure all of your connections are correct.
 41. Press escape and answer yes when asked if you want to abandon this new order.
 42. Press escape until you return to the # prompt.
 43. Type in `exit` and press enter.
- At this point the scale is set up and ready for use.

Setting up the Model 6710 Produce Scale

Warning: Turn the power off to the terminal before connecting the scale.

